

DEMAND LAOD in kW for Total Project	321 kW
5.00 % OF DEMAND LAOD in kW for Total Project	16.05kW
NO OF SOLAR PV @ 380 W/pv panel	42
NO OF SOLAR PV PER BLDG.(RESIDENTIAL)	42

(1) CERTIFICATE OF ARCHITECT:-
I CERTIFY THAT ALL THE ARCHITECTURAL DRAWINGS OF THE PROJECT AT PREMISES NO. IIF-005, PLOT NO. II F/5, HAVE BEEN PREPARED BY ME COMPLYING WITH THE NEW TOWN KOLKATA BUILDING RULES, 2009. I ALSO CERTIFY THAT THE PLANS AND DRAWINGS PREPARED BY ME COMPLY WITH ALL PROVISIONS REGARDING THE FIRE PROTECTION AS PER THE PREVAILING NATIONAL BUILDING CODE. I SHALL BE HELD RESPONSIBLE IF ANY INCORRECT INFORMATION IS FURNISHED BY ME OR ANY VIOLATION OF PROVISIONS OF THESE RULES OR THE PREVAILING NATIONAL BUILDING CODE IS FOUND IN ANY OF THE DRAWINGS AND DOCUMENTS, SIGNED BY ME AND SUBMITTED TO THE SANCTIONING AUTHORITY FOR OBTAINING SANCTION.

Aditya Goswami
ADITYA GOSWAMI
Regd. No. CA/2004/33103
Registered with the Council
of Architects, India
ACHR/NKDA/10/00072

ADITYA GOSWAMI
ACHR / NKDA / 10 / 00072
NAME OF ARCHITECT

(2) CERTIFICATE OF THE STRUCTURAL ENGINEER:-
CERTIFIED THAT THE STRUCTURAL DRAWING & DESIGN OF BOTH THE FOUNDATION AND SUPERSTRUCTURE OF THE BUILDING HAS BEEN MADE CONSIDERING THE SOIL TEST REPORT, AS PER THE RULES & REGULATIONS MADE UNDER THE ACT AND ALSO CONSIDERING ALL POSSIBLE LOADS, SEISMIC LOAD & THE MOMENTS GENERATED BY THE PROPOSED STRUCTURE AS PER THE BUREAU OF INDIAN STANDARD & NATIONAL BUILDING CODE OF INDIA & CERTIFIED THAT IT IS SAFE AND STABLE IN ALL RESPECT AND THESE PROVISIONS SHALL BE ADHERED TO DURING THE CONSTRUCTION.

Sanjiv J. Parekh
SANJIV J. PAREKH
M.E. (STRUC. ENGRG.)
R.C.E. (I) E-000024
STER/NKDA/10/00030

SANJIV J. PAREKH
ENROLLMENT NO.- STER / NKDA / 10 / 00030
NAME OF STRUCTURAL ENGINEER

(3) CERTIFICATE OF THE URBAN DESIGNER:-
RUNA GOSWAMI, M.Arch,
Regd. No. CA/2004/33104
Registered with the Council
of Architects, India
UDER/NKDA/21/00002

Runa Goswami
RUNA GOSWAMI
ENROLLMENT NO.- UDER/NKDA/21/00002
NAME OF URBAN DESIGNER

(4) CERTIFICATE OF THE GEO-TECHNICAL ENGINEER:-
IT IS CERTIFIED THAT THE COMPREHENSIVE GEO-TECHNICAL REPORT ON SOIL INVESTIGATION HAS BEEN PREPARED BY ME FOR DESIGN & CALCULATION OF THE FOUNDATION BY ANALYZING THE SOIL SAMPLE FOR ESTIMATING THE BEARING CAPACITY OF THE SOIL ON WHICH FOUNDATION OF THE STRUCTURE WILL BE CONSTRUCTED. I SHALL ALSO CHECK THE NATURE OF THE SOIL AFTER EXCAVATING THE SITE SO THAT FOUNDATION IS EXTENDED UP TO APPROPRIATE DEPTH THAT HAS BEEN PROPOSED IN THE GEO-TECHNICAL REPORT.

Jishnu Pal
JISHNU PAL
D. Tech. (Geotech. E. E. (Geo-techn)
I.C.E. Reg. No. G. 171/12
G.I.E.R. (MCA) / 10 / 0043
22/BJBSON/G. 14/2016-17
MHC Reg. No. 807E/CLASS-1713

JISHNU PAL
ENROLLMENT NO.- GTER / NKDA / 10 / 00043
NAME OF GEO-TECHNICAL ENGINEER

(5) I / WE CONFIRM THAT THE ERECTION OF BUILDING TO BE UNDERTAKEN SHALL BE STRICTLY IN ACCORDANCE WITH THE ACT AND THE RULES MADE THEREUNDER. NO BUILDING MATERIALS SHALL BE DEPOSITED IN ANY STREET EXCEPT WITH THE WRITTEN PERMISSION OF THE SANCTIONING AUTHORITY. I/WE SHALL NOT TRANSFER THE OPEN SPACE OR ANY PART THEREOF SHOWN IN BUILDING PLAN, AS LAND APURTENANCE TO THE PROPOSED BUILDING.

Anand Neotia
ANAND NEOTIA
DIRECTOR
REB ANKASATI GLOBE PROPERTIES PVT. LTD.

SIGNATURE OF APPLICANT(S)
ANAND NEOTIA
(CHAIRMAN) OF REB ANKASATI GLOBE
PROPERTIES PRIVATE LIMITED,
1 GARSTIN PLACE, P.A. - HARI STREET,
KOLKATA-700001

PROJECT NAME:-
REVISED PLAN FOR PROPOSED B+G+XXII STORED IT/ITES BUILDING AND B+G+XXII STORED RESIDENTIAL BUILDING, AT PREMISES NO. 03-0370, REGISTERED AS PLOT NO.- AA-IIF/5, CATEGORY II PLOT, ACTION AREA 2F, NEW TOWN, KOLKATA (PREVIOUSLY SANCTIONED ON 24 MAY 2018, VIDE PIN NO. IIF0000520180404 WITH BUILDING PARTICULARS 2B+G+XXVI STORED IT & ITES BUSINESS BUILDING AT PREMISES NO. IIF/5, PLOT NO. II F/5, BLOCK-II F ACTION AREA - II, NEW TOWN, RAJARHAT, KOLKATA).

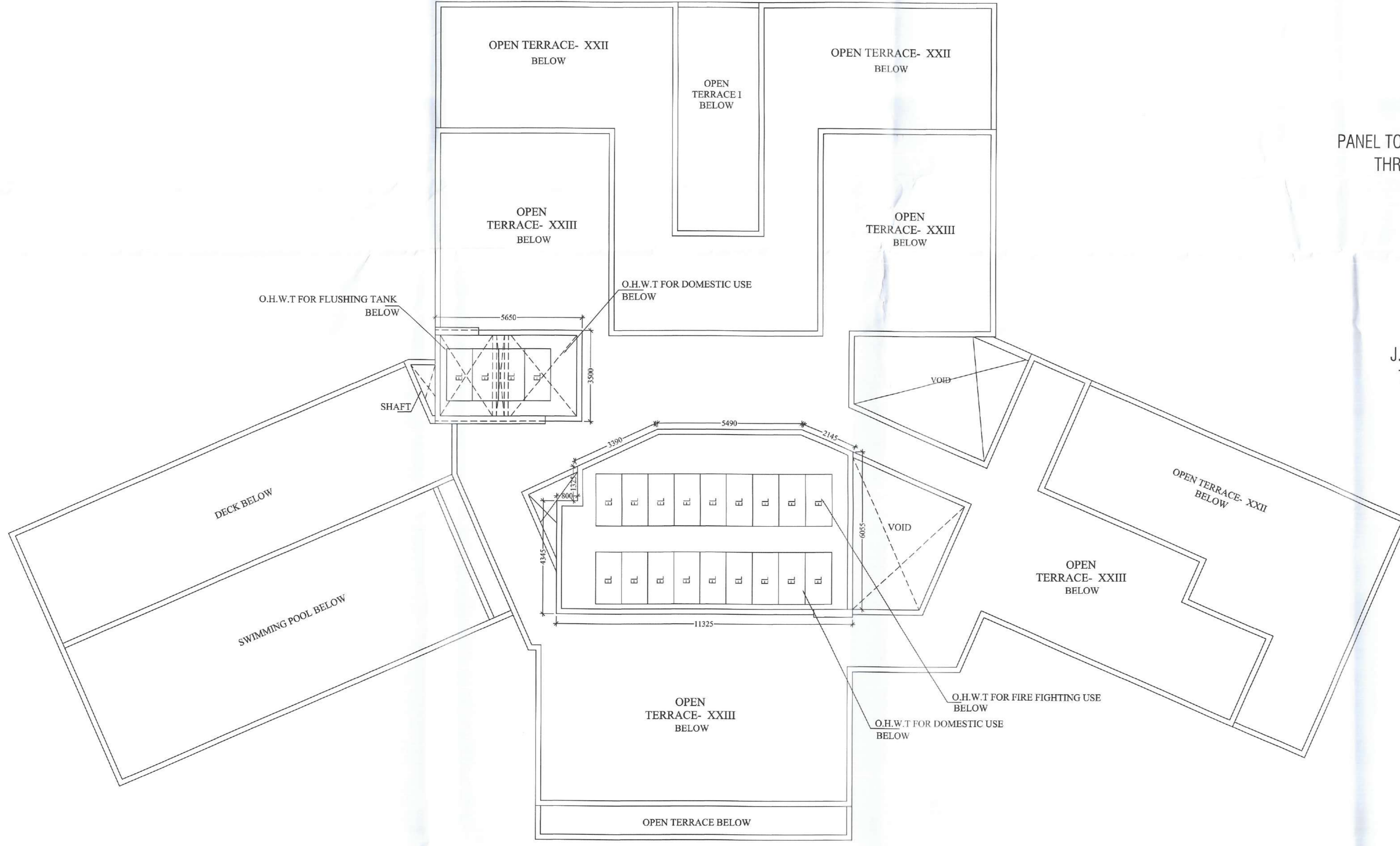

ABOVE ROOF PLAN
SCALE = 1:100

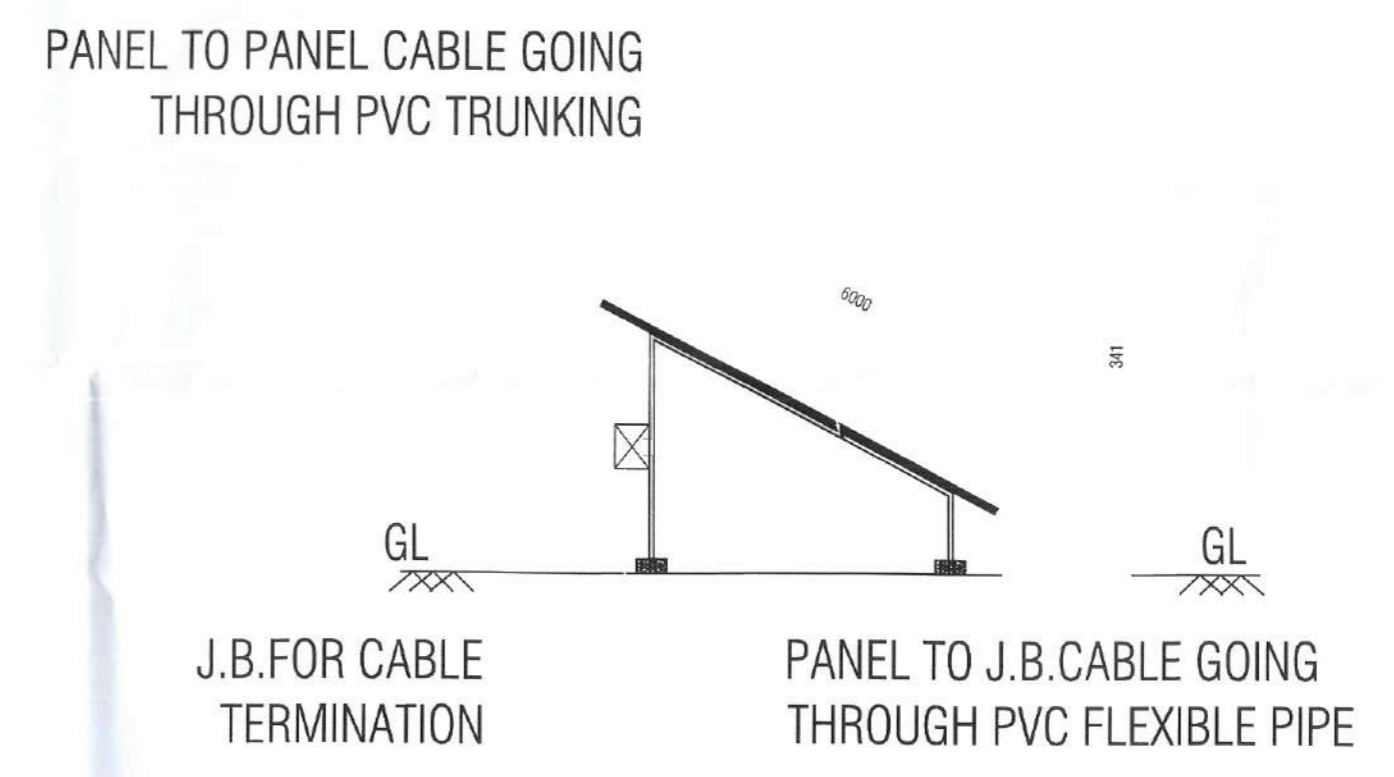

NOTES AND SPECIFICATIONS
1. ALL DIMENSIONS ARE IN MM. UNLESS OTHERWISE NOTED.
2. PRODUCTION OF CHAJJA & CORNICE IS 500 MM.
3. ALL OTHER SPECIFICATION AS PER IS CODE OR N.B.C.
4. 19MM THK. PLASTER TO OUTER WALLS AND 12MM THK. PLASTER TO INNER WALLS AND 6MM THK. PLASTER TO CEILING.
5. EXTERNAL WALLS ARE 200 MM THK. AND ALL INTERNAL WALLS ARE 100 MM THK. UNLESS OTHERWISE MENTIONED IN THE DRAWING.
LEGEND:
F.C.D. - FIRE CHECK DOOR
W.T.F. - WATER TIGHT FLOORING
F.G. - FIXED GLASS
E.C.C.P. - ELECTRIC CAR CHARGING POINT

DOOR & WINDOW SCHEDULE					
DOOR SCHEDULE			WINDOW SCHEDULE		
MRKD.	WIDTH	LINTEL HEIGHT	MRKD.	WIDTH	WINDOW HEIGHT
F.C.D.					
D	1200	2250	W1	2600	1800
D1	1500	2250	W2	2400	1800
D2	1050	2250	W3	1725	1800
D3	900	2250	W4	1250	1000
D4	750	2250	W5	1200	1400
D5	950	2250	W6	1075	1400
SD1	5000	2250	W7	950	1400
SD2	3250	2250	W8	600	1200
SD3	2750	2250	W9	600	1000
SD4	2400	2250	W10	1750	1800
SD5	2350	2250	W11	2350	1800
SD6	3300	2250	W12	600	1000
SD7	3475	2250	W13	3250	1800
			W14	3100	1800
			W15	1300	1000

TITLE :- ABOVE ROOF PLAN
(RESIDENTIAL BUILDING)

DATE: 21.09.2022
SCALE: 1:100
DRG. NO. ATR/320/MUN/26
DRAWN BY: [Signature]
APPROVED BY: [Signature]
CONSULTANT: [Signature]

ARCHITECTONIC SERVICES
architects
engineers
urban designers

KOLKATA: Amrapur Alkapur, First Floor, 17A, Aali Roy Road, Kolkata - 700029, India. +91-33-4008 6483
DELHI: 375, Main Shivaji Road, Malviya Nagar, First Floor, New Delhi - 110017, India. +91-11-4106 5344
Email: architectonicservices@gmail.com www.architectonicservices.com

PARTY'S COPY

APPROVED FOR CONSTRUCTION
Any unauthorized construction done in violation
from approved building plans, after issuance of
this permission, will warrant revocation of the
consent/permission.
STRUCTURAL DRAWINGS, STRUCTURAL
DESIGN CALCULATIONS & SOIL TEST
REPORT ARE NOT CHECKED AND KEPT
FOR RECORDS ONLY.

LEVEL OF TOP OF THE BOX DRAIN
AND LEVEL OF EXIT/ ENTRY
ALONG THE PROPERTY LINE OF
ANY FOOT SHOULD BE AT PAR. THE
ENTRY & EXIT SHOULD BE MADE WITH
TEMPORARY TYPE OF CONSTRUCTION,
LIKE PAVERS BLOCK OR EQUIVALENT.

NEW TOWN KOLKATA DEVELOPMENT AUTHORITY
Section of Building Plan for Construction Purpose

VALID FOR 5 YEARS

No. and date: 01/1/2022
PIN: R00300270020220929

Building Particulars Bt(1+XXII) stated IT and ITeS business
Building. At POC NO. - 03-0370.

Susmit Majumdar
Assistant Architect
New Town Kolkata Development Authority

Tapan Kumar Dwari
Chief Architect
New Town Kolkata Development Authority